

Ultra compact MDS pouch-filling automation

- Easy, one-person operation to prepare MDS pouch prescriptions, scale up without more staff cost
- Differentiate your prescription service with easy-to-follow medication instructions and pictures
- Reduce prescription errors and improve patient loyalty
- Reduce inventory waste with expiring medication detection
Increase storage space within your pharmacy
- Interfaces with a range of PMR systems for integrated workflow



Options at a glance



Automatically inspect completed pouches to detect any possible errors



Automated canister for automatic packing of halved and special shaped tablets



Scale output with additional canisters, magazine and trays

Set up needs

Installation

- 1x power socket minimum
(2 recommended as a back-up)
- 1x network point minimum
(2 recommended as a back-up)

Software

- Patient Medication Record (PMR) integration.
- PMR interface varies according to the country of installation. PMR interface can be developed on demand. UK PMR interface examples:
- EMIS-Proscript, PSL (Analyst), Cegedim, RxWeb, Apotec

Machines specifications

	JVM DO
Floor space	0.6m ²
Dimensions	990mm (w), plus 300mm each side when a door is opened 630mm (d), 2,150mm (h)
Maximum operating speed	Up to 50 multi-dose pouches filled per minute
Weight	300KG
Touch screens	26cm embedded touch screen (10.4")
Electrical supply	220-240V, 450/60Hz
Power consumption	550W
Operating temperature	0-40°C

Customisable configuration

Auto-Canister: **JVM-OPT-001**



Automatically dispense and package quarter and half dose tablets, and special shaped tablets. Some restrictions apply, contact your Omnicell sales representative for more information

Additional canisters: **JVM-OPT-012**



To extend your library of medications, beyond the canisters that come us standard with your machine. A minimum order of 10 additional canisters applies

Automatic pouch inspection system: **Vizen JV-VE10**



With the Vizen EX Inspection Check each completed pouch can be verified to detect any possible errors, streamlining your manual pharmacy check process

STS Load Station: **JVM-OPT-002** + STS Assist Tray: **JVM-OPT-013**



Provides sensor-controlled and light-guided manual loading of special-shaped, half dose or infrequently used medications, to improve accuracy and reduce handling time

Customisable configuration (continued)

STS Assist Tray: **JVM-OPT-013** + STS Guide Light: **JVM-OPT-003**



To provide light-guided manual loading of special-shaped, half dose or infrequently used medications, to improve accuracy and reduce handling time

STS Assist Tray: **JVM-OPT-013**



To assist with manual loading of special-shaped, half dose or infrequently used medications, to reduce handling time

Packet Roller: **JVM-OPT-004**



Conveniently feeds the pouch strip into the JVM 208DO with automatic tensioning to speed up machine operation

JVM DO Dimension Drawings

Measurements in mm

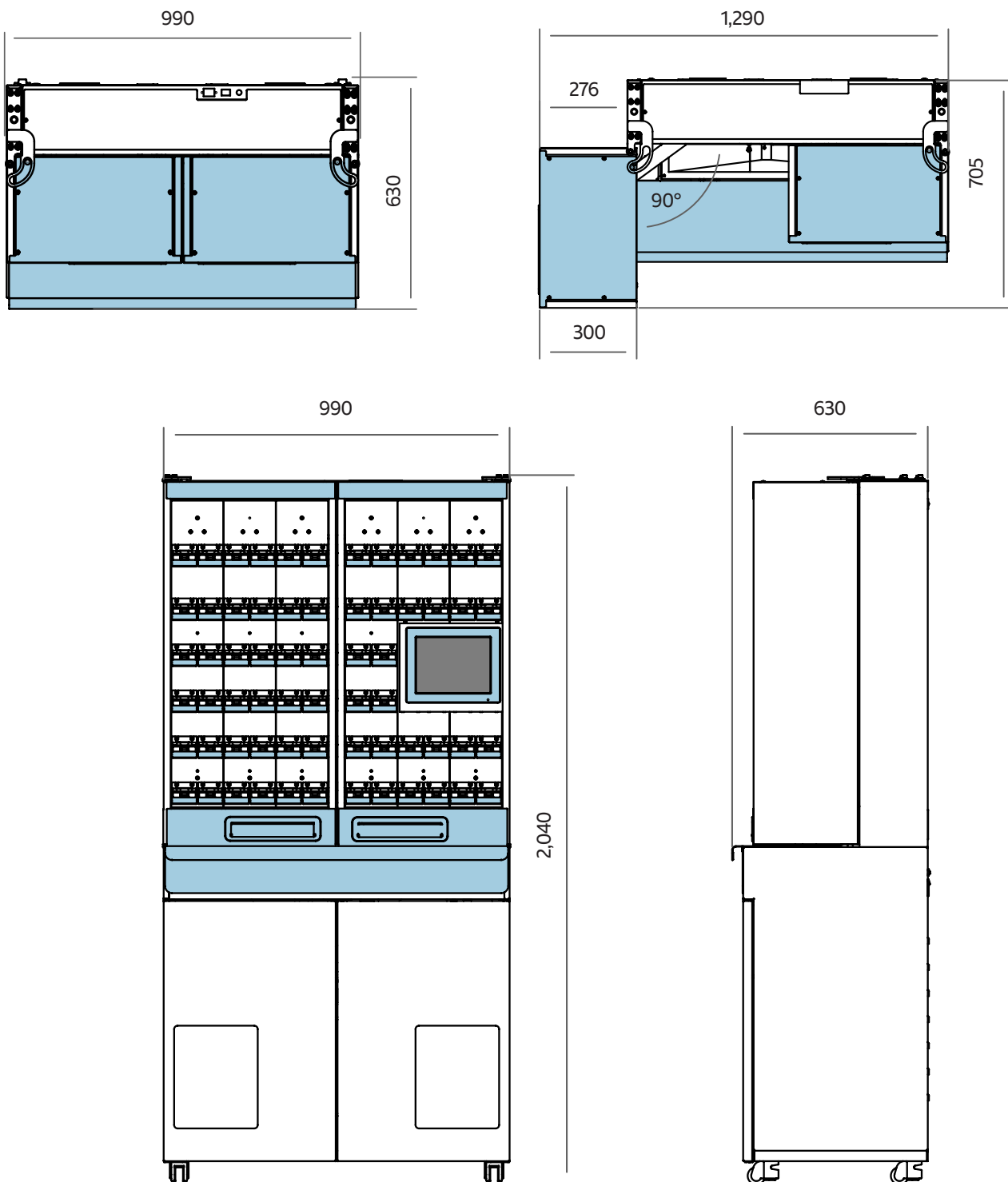

Model	Size (mm)	Weight (kg)	Canister (ea)
JVM DO	990mm (w) plus 300mm each side when a door is opened 630mm (d), 2,040 (h)	300	208

Vizen EX Inspection Check (optional) Dimension Drawings

Measurements in mm

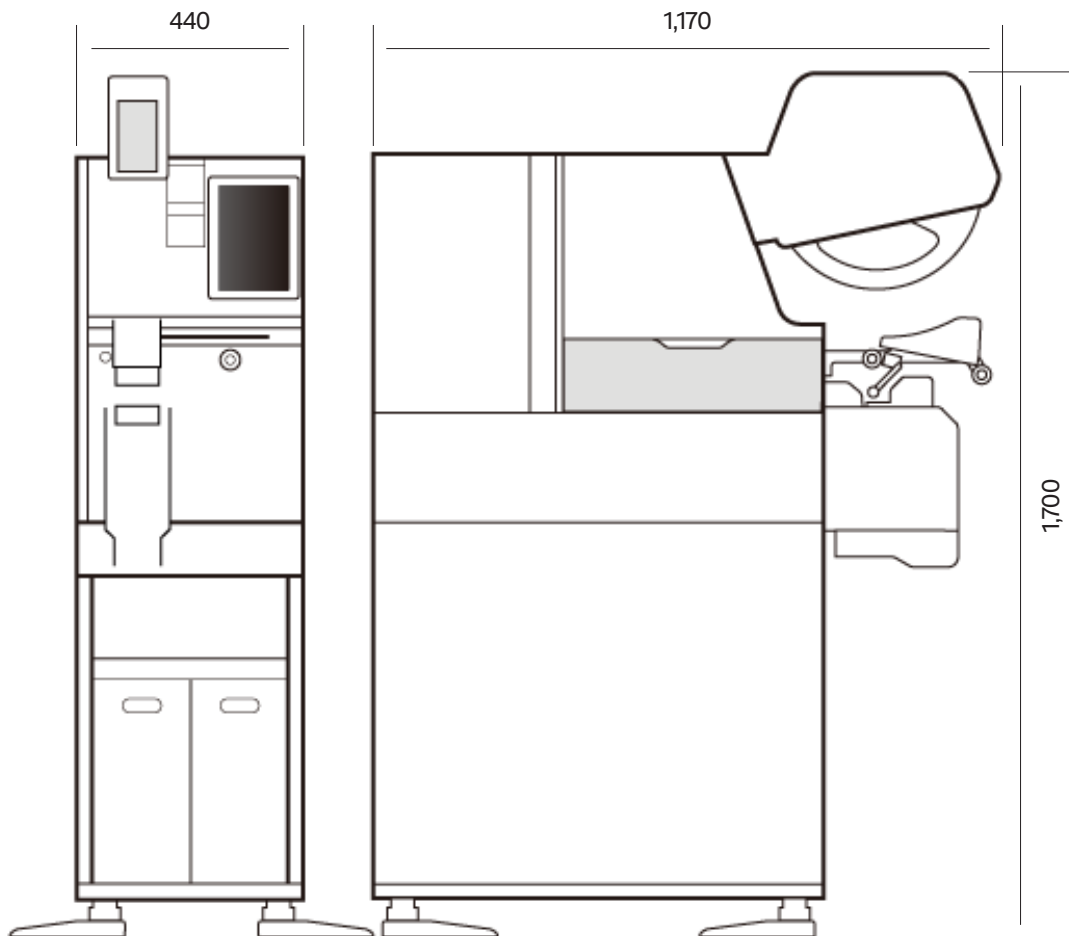

Model	Size (mm)
Vizen EX Inspection Check	440mm (w) x 1,170mm (d) x 1,700 (h)